

FOR SALE

RESIDENTIAL - CONDOMINIUM 1,259SQFT (117SQM) / CALL FOR PRICE!

+65-62530030

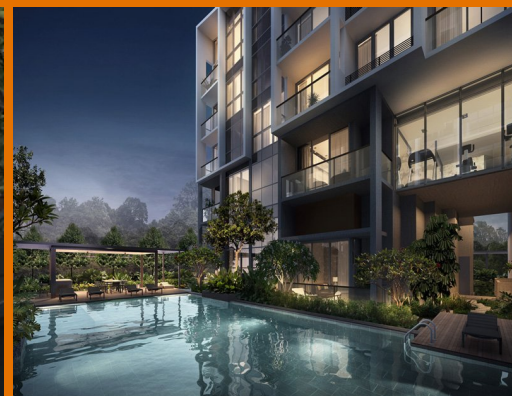

3 - Bedroom Premium

TYPE C2
#03-12, #04-12
#03-02, #04-02 (mirror)
117 sq m / 1259 sq ft

TYPE C2-R

#05-12
#05-02 (mirror)
158 sq m / 1679 sq ft
includes 39 sqm / 420 sq ft void area
(high ceiling) above living/dining,
bedroom 1 & balconies



RESIDENTIAL - CONDOMINIUM

**THE ESSENCE, 1, CHONG KUO ROAD, SINGAPORE
779830**

- **LISTING ID:** SGLD96199908
- **TENURE:** LEASEHOLD 99
- **TITLE:** N/A
- **SIZE BUILT-UP:** 1,259SQFT (117SQM)
- **SITE AREA:** 46,092SQFT (4,282SQM)
- **NO. OF FLOORS:** 5
- **FLOOR/LEVEL:** N/A - MIDDLE FLOOR
- **BED ROOMS:** 3
- **BATH ROOMS:** 3
- **MAIDS ROOMS:** N/A
- **PARKING SPACES:** N/A
- **LAYOUT TYPE:** CORNER
- **FACING:** N/A
- **VIEWING:** N/A
- **SELLING PRICE:** **CALL FOR PRICE!**
- **COMPLETION YEAR:** 2021, 0YRS
- **CONDITION:** ORIGINAL CONDITION
- **FURNISHING:** PARTIALLY FURNISHED
- **LISTING DATE:** MAY 7, 2021

THE ESSENCE

3 Bedroom Premium - Unit Type C2, Spacious 1,227sqft (114sqm), 3 bedroom, 3 bathroom Condominium for Sale. TOP 2021, this middle floor unit is in original condition. Others: Leasehold 99 Located in Singapore's district D26 near Mandai, Upper Thomson in the area North (North region).

INTERIOR FACILITIES

- Balcony

OTHER INTERIOR FEATURES

- Cooker Hob/Hood
- Fridge
- Dryer
- Oven / Microwave

EXTERIOR FACILITIES

- 24 Hours Security
- Pool Deck
- Covered Car Park
- Pavilion

VISIT THIS PROPERTY AT: <https://projects.huttonsgroup.com/the-essence/property/sgld96199908>

HUTTONS ASIA PTE LTD

📍 3 Bishan Place #05-01 CPF Bishan Building
579838, Singapore

📞 +65-62530030

✉ sales@huttonsgroup.com

🌐 <https://projects.huttonsgroup.com/the-essence>

Huttons
The Agency of Choice

L3008899K



Scan QR Code