

FOR SALE

RESIDENTIAL - CONDOMINIUM 1,076SQFT (100SQM) / CALL FOR PRICE!

+65-97611282

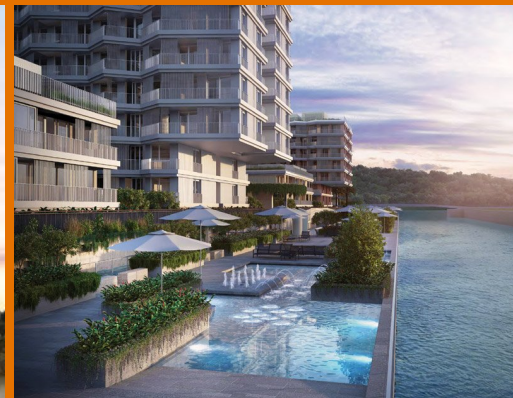

3 - Bedroom + Study

TYPE CS1

100sqm | 1,076sqft

TYPE CS1-P

100sqm | 1,076sqft

TYPE CS1-L

119sqm | 1,281sqft

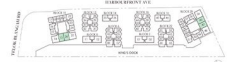

RESIDENTIAL - CONDOMINIUM HARBOURFRONT AVENUE, SINGAPORE 097993

- LISTING ID: SGLD69351398
- TENURE: LEASEHOLD 99
- TITLE: N/A
- SIZE BUILT-UP: 1,076SQFT (100SQM)
- SITE AREA: 6.526AC (2.641HA)
- NO. OF FLOORS: 10
- FLOOR/LEVEL: N/A - N/A
- BED ROOMS: 3+1
- BATH ROOMS: 2
- MAIDS ROOMS: N/A
- PARKING SPACES: N/A
- LAYOUT TYPE: OTHER
- FACING: N/A
- VIEWING: OTHER
- SELLING PRICE: **CALL FOR PRICE!**
- COMPLETION YEAR: 2025
- CONDITION: ORIGINAL CONDITION
- FURNISHING: PARTIALLY FURNISHED
- LISTING DATE: FEB 10, 2021

THE REEF AT KING'S DOCK

Condominium for Sale: Partially furnished, 3 bedroom, 2 bathroom + study. Completed in 2025, this unit is in original condition. Tenure: Leasehold 99 Located in Singapore's district D04 near Harbourfront, Telok Blangah in the area Keppel (Central region).

INTERIOR FACILITIES

- Air-Conditioning
- Balcony

OTHER INTERIOR FEATURES

- Cooker Hob/Hood
- Dishwasher
- Dryer
- Fridge

EXTERIOR FACILITIES

- 24 Hours Security
- Clubhouse
- Covered Car Park
- Jacuzzi

VISIT THIS PROPERTY AT: <https://projects.huttonsgroup.com/the-reef-at-kings-dock/property/sgld69351398>

HUTTONS ASIA PTE LTD

3 Bishan Place #05-01 CPF Bishan Building
579838, Singapore

+65-97611282

sales@huttonsgroup.com

<https://projects.huttonsgroup.com/the-reef-at-kings-dock>

Huttons
The Agency of Choice

L3008899K



Scan QR Code