

FOR SALE

RESIDENTIAL - CONDOMINIUM 1,076SQFT (100SQM) / CALL FOR PRICE!

+65-81868917



3 - Bedroom Premium

Type C3a(pd)
88 sqm (1055 sqft)
Block 36
#01-08

Type C3a(PH)
127 sqm (1392 sqft)
Strata hold area of 23 sqm (247 sqft above
parking deck) with high volume ceiling of
4.05m to 4.1m.
Balcony at top floor is provided with canopy.

Type C3a
96 sqm (1055 sqft)
Block 36
#02-08 To #04-08

Block 36
#05-08

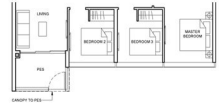

RESIDENTIAL - CONDOMINIUM TOH TUCK ROAD, CLEMENTI PARK, UPPER BUKIT TIMAH, SINGAPORE 596710

- LISTING ID: SGLD62827528
- TENURE: FREEHOLD
- TITLE: N/A
- SIZE BUILT-UP: 1,076SQFT (100SQM)
- SITE AREA: 8.267AC (3.346HA)
- NO. OF FLOORS: 9
- FLOOR/LEVEL: N/A - N/A
- BED ROOMS: 3
- BATH ROOMS: 3
- MAIDS ROOMS: N/A
- PARKING SPACES: N/A
- LAYOUT TYPE: INTERMEDIATE
- FACING: N/A
- VIEWING: PARK / GREENERY VIEW
- SELLING PRICE: **CALL FOR PRICE!**
- COMPLETION YEAR: 2024
- CONDITION: ORIGINAL CONDITION
- FURNISHING: N/A
- LISTING DATE: MAY 11, 2021

FORETT AT BUKIT TIMAH

Spacious 1,076sqft (100sqm), 3 bedroom, 3 bathroom
Condominium for Sale. Completion in 2024, this intermediate
unit is in original condition. Others: freehold, park / greenery
view Located in Singapore's district D21 near Clementi Park,
Upper Bukit Timah in the area Central West (Central region).

INTERIOR FACILITIES

- Balcony
- Cable TV

OTHER INTERIOR FEATURES

- Cooker Hob/Hood

EXTERIOR FACILITIES

- 24 Hours Security
- Clubhouse
- Covered Car Park
- Landscaped Garden

VISIT THIS PROPERTY AT: <https://projects.huttonsgroup.com/forett-at-bukit-timah/property/sglD62827528>

HUTTONS ASIA PTE LTD

📍 3 Bishan Place #05-01 CPF Bishan Building
579838, Singapore

📞 +65-81868917

✉ sales@huttonsgroup.com

🌐 <https://projects.huttonsgroup.com/forett-at-bukit-timah>

Huttons
The Agency of Choice

L3008899K



Scan QR Code