

# FOR SALE

## RESIDENTIAL - LANDED HOUSE 646SQFT (60SQM) / CALL FOR PRICE!

+65-62530030



1 - Bedroom + Study

### TYPE ASI-H

60 sqm/ 646 sqft \*\*

BLOCK 50 #05-10  
BLOCK 66A #05-82  
BLOCK 68A #05-93\*

\* MIRROR UNIT  
\*\* AREA IS INCLUSIVE OF STRATA VOID AREA ABOVE LIVING AND DINING AS PER DOTTED LINE.

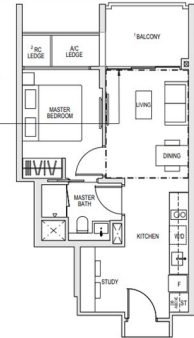

### TYPE ASI

48 sqm/ 517 sqft

BLOCK 50 #02-10 TO #04-10  
BLOCK 66A #02-82 TO #04-82  
BLOCK 68A #02-93\* TO #04-93\*

\* MIRROR UNIT

### TYPE ASI-P

48 sqm/ 517 sqft

BLOCK 50 #01-10  
BLOCK 66A #01-82  
BLOCK 68A #01-93\*

\* MIRROR UNIT

## RESIDENTIAL - LANDED HOUSE 50 SOUTH BUONA VISTA ROAD, SINGAPORE 118167

- LISTING ID: SGLD39252057
- TENURE: LEASEHOLD 99
- TITLE: LAND TITLE
- SIZE BUILT-UP: 646SQFT (60SQM)
- SIZE LAND: N/A
- NO. OF FLOORS: 5
- FLOOR/LEVEL: N/A - MIDDLE FLOOR
- BED ROOMS: 1+1
- BATH ROOMS: 1
- MAIDS ROOMS: N/A
- PARKING SPACES: N/A
- LAYOUT TYPE: OTHER
- FACING: N/A
- VIEWING: N/A
- SELLING PRICE: **CALL FOR PRICE!**
- COMPLETION YEAR: 2027
- CONDITION: ORIGINAL CONDITION
- FURNISHING: PARTIALLY FURNISHED
- LISTING DATE: APR 17, 2019

## KENT RIDGE HILL RESIDENCES

Landed House for Sale: Partially furnished. 2 bedroom, 1 bathroom. Completed in 2027, this unit is in original condition. Tenure: leasehold 99 Located in Singapore's district D05 near Buona Vista, West Coast, Clementi in the area South West (Central region).

### INTERIOR AND FEATURES

- Air-Conditioning
- Bombshelter
- Fiber-Internet

### FACILITIES

- Fridge
- Oven / Microwave
- Intercom
- Washing Machine

### AMENITIES

- 24 Hours Security
- Clubhouse
- Billiards Room
- Covered Car Park

VISIT THIS PROPERTY AT: <https://www.kentridgehillresi.sg/property/sgld39252057>

## HUTTONS ASIA PTE LTD

3 Bishan Place #05-01 CPF Bishan Building  
579838, Singapore

+65-62530030

sales@huttonsgroup.com

<https://www.kentridgehillresi.sg>

**Huttons**  
The Agency of Choice

L3008899K



Scan QR Code