

FOR SALE

RESIDENTIAL - CONDOMINIUM 624SQFT (58SQM) / CALL FOR PRICE!

+65-94884490



1 - Bedroom

Type A

Unit #03-02 to #22-02
Area 624 sqft / 58 sqm
(inclusive of planter, a/c ledge & balcony)

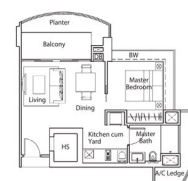

RESIDENTIAL - CONDOMINIUM

**LUCIDA, 2, SUFFOLK ROAD, NEWTON, NOVENA,
SINGAPORE 307780**

- LISTING ID: SGLD29913160
- TENURE: FREEHOLD
- TITLE: N/A
- SIZE BUILT-UP: 624SQFT (58SQM)
- SITE AREA: 20,383SQFT (1,894SQM)
- NO. OF FLOORS: 29
- FLOOR/LEVEL: N/A - MIDDLE FLOOR
- BED ROOMS: 1
- BATH ROOMS: 1
- MAIDS ROOMS: N/A
- PARKING SPACES: N/A
- LAYOUT TYPE: REGULAR
- FACING: N/A
- VIEWING: OTHER
- SELLING PRICE: **CALL FOR PRICE!**
- COMPLETION YEAR: 2012, 7YRS
- CONDITION: ORIGINAL CONDITION
- FURNISHING: PARTIALLY FURNISHED
- LISTING DATE: JUL 24, 2019

LUCIDA

Partially furnished, 1 bedroom, 1 bathroom Condominium for Sale. Completed in 2012, this middle floor unit is in original condition. Others: Freehold This property is currently vacant and ready to move in. Located in Singapore's district D11 near Newton, Novena in the area Newton (Central region).

INTERIOR AND FEATURES

- Air-Conditioning
- Balcony

FACILITIES

- Cooker Hob/Hood
- Dishwasher
- Fridge
- Intercom

AMENITIES

- 24 Hours Security
- Covered Car Park
- Jacuzzi
- Landscaped Garden

VISIT THIS PROPERTY AT: <https://projects.huttonsgroup.com/lucida/property/sgld29913160>

HUTTONS ASIA PTE LTD

📍 3 Bishan Place #05-01 CPF Bishan Building
579838, Singapore

📞 +65-94884490

✉ sales@huttonsgroup.com

🌐 <https://projects.huttonsgroup.com/lucida>

Huttons[®]

The Agency of Choice

L3008899K



Scan QR Code