

# FOR SALE

## RESIDENTIAL - CONDOMINIUM 1,324SQFT (123SQM) / CALL FOR PRICE!

+65-94884490



3 - Bedroom

Type C

Unit #13-01 to #22-01  
Area: 1324 sqft / 123 sqm  
(inclusive of planter, a/c ledge & balcony)

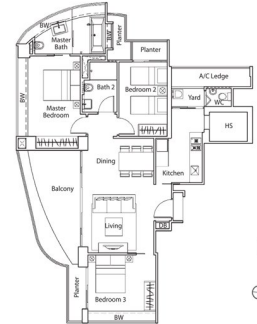

### RESIDENTIAL - CONDOMINIUM

**LUCIDA, 2, SUFFOLK ROAD, NEWTON, NOVENA, SINGAPORE 307780**

- LISTING ID: SGLD00978637
- TENURE: FREEHOLD
- TITLE: N/A
- SIZE BUILT-UP: 1,324SQFT (123SQM)
- SITE AREA: 20,383SQFT (1,894SQM)
- NO. OF FLOORS: 29
- FLOOR/LEVEL: N/A - MIDDLE FLOOR
- BED ROOMS: 3
- BATH ROOMS: 2
- MAIDS ROOMS: N/A
- PARKING SPACES: N/A
- LAYOUT TYPE: REGULAR
- FACING: N/A
- VIEWING: OTHER
- SELLING PRICE: **CALL FOR PRICE!**
- COMPLETION YEAR: 2012, 7YRS
- CONDITION: ORIGINAL CONDITION
- FURNISHING: PARTIALLY FURNISHED
- LISTING DATE: JUL 24, 2019

### LUCIDA

Spacious 1,324sqft (123sqm), partially furnished, 3 bedroom, 2 bathroom Condominium for Sale. Completed in 2012, this middle floor unit is in original condition. Others: Freehold This property is currently vacant and ready to move in. Located in Singapore's district D11 near Newton, Novena in the area Newton (Central region).

### INTERIOR AND FEATURES

- Air-Conditioning
- Balcony

### FACILITIES

- Cooker Hob/Hood
- Dishwasher
- Fridge
- Intercom

### AMENITIES

- 24 Hours Security
- Covered Car Park
- Jacuzzi
- Landscaped Garden

VISIT THIS PROPERTY AT: <https://projects.huttonsgroup.com/lucida/property/sgld00978637>

### HUTTONS ASIA PTE LTD

3 Bishan Place #05-01 CPF Bishan Building  
579838, Singapore

+65-94884490

sales@huttonsgroup.com

<https://projects.huttonsgroup.com/lucida>

**Huttons**  
The Agency of Choice

L3008899K



Scan QR Code